

Lifting ring SPAZ

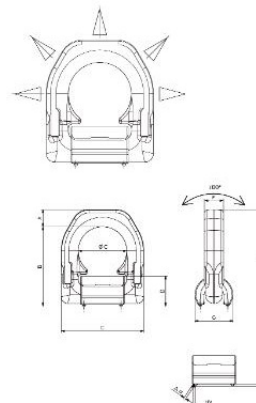

- Inele de prindere sudabile
- Punct de prindere cu fixare prin sudura cu o singura baza – SPAZ/ Grad 8
- Inel pentru ridicarea sarcinilor sudabil.
- Pentru sarcini asimetrice aduceți-va aminte ca capacitatea de ridicare trebuie redusa asa cum este aratat in tabelul de referinta.
 - Punctul de ancorare poate fi utilizat in conditii de siguranta pana la 20.000 de ridicari la capacitatea maxima
 - Coeficient de securitate 4
 - Inel testat 100% magnaflux
 - Fabricat din otel de inalta rezistenta
 - Acoperit cu vopsea epoxidica
 - Testat la 20.000 cicluri de utilizare



DATE TEHNICE

- Ring to be welded for load lifting.
- For asymmetric loads remember that the capacity has to be reduced as shown in the reference table.
- -The anchorage clamp can be used safely up to maximum of 20.000 lifts with a full load
 - Safety coefficient 4
 - Ring tested 100 % magnaflux
 - Made in high resistant steel
 - Painted with epoxy paint
 - Tested at 20.000 stress cycles

Maße / Measurements

Artikel ohne Feder Article without spring	Artikel mit Feder Article with spring	WLL WLL	A	B	C	D	E	F	G	H	Dicke der Schweißnaht Welding thickness	Gewicht ca. kg Weight approx.
31803001	31803001F	1,5	14	65	38,0	25	66	16,0	31,0	79	HV 5-3	0,39
31803002	31803002F	2,5	16	75	45,0	27	77	18,0	34,5	91	HV 7-3	0,59
31803004	31803004F	4,0	18	84	51,0	32	87	20,0	40,0	102	HV 8+3	0,87
31803006	31803006F	6,7	24	117	67,3	44	115	26,0	58,5	141	HV 12+4	2,23
31803010	31803010F	10,0	31	126	67,0	55	129	28,5	70,5	157	HV 16+4	3,33
31803016	31803016F	16,0	45	174	100,0	69	190	42,0	87,0	219	HV 25+6	9,28

Tragfähigkeiten / WLLs



Artikel ohne Feder Article without spring	Artikel mit Feder Article without spring	0° 1Strang Single leg	0° 2Stränge 2 legs	90° 1Strang Single leg	90° 2Stränge 2 legs	0°-45°	45°-60° 2Stränge 2 legs	Asym.	0°-45°	45°-60° 4Stränge 4 legs	Asym.
31803001	31803001F	1,5	3,0	1,5	3,0	2,1	1,5	1,5	3,15	2,25	1,5
31803002	31803002F	2,5	5,0	2,5	5,0	3,5	2,5	2,5	5,25	3,75	2,5
31803004	31803004F	4,0	8,0	4,0	8,0	5,6	4,0	4,0	8,40	6,00	4,0
31803006	31803006F	6,7	13,4	6,7	13,4	9,5	6,7	6,7	14,00	10,00	6,7
31803010	31803010F	10,0	20,0	10,0	20,0	14,0	10,0	10,0	21,00	15,00	10,0
31803016	31803016F	16,0	32,0	16,0	32,0	22,4	16,0	16,0	33,60	24,00	16,0

Total Race Impex SRL J40/20761/2006 , RO 19794573 , Bucuresti, sector 6 , Bulevardul Uverturii , nr.69A, cod:060933 Mobil:0728305610/ 0728305611 / 0728305612; fax: 0214301206;tel/fax :0314201202 E-mail:info@totalrace.ro;vanzari@totalrace.ro

Website:www.totalrace.ro , www.lanturideridicare.ro , www.chingimacarale.ro , www.benziambalare.ro , www.banadaancorare.rowww.lanturichingi.ro , www.carligemacarale.ro , www.echipamentemacara.ro , www.benebeton.ro , www.clestiridicare.ro .